



Specifications

Arlu® (Argenta®)

Pivotica 45kg

The argenta® pivotica® is thanks to its compact size not only easy to mount in the door, the pivot hinge can also be installed in pivoting floor-to-ceiling-height doors.



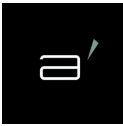

The innovative pivot hinge allows for the pivot point on the door to be chosen freely (at a minimum of 40 mm from the side of the door); this way, wide doors can for instance rotate from the middle.

The argenta pivotica is suitable for both left and right doors. Thanks to the argenta pivotica architects can use spaces and walls creatively, seeing how the pivot hinge does not require a door frame and the door can be aligned perfectly with the wall. All parts of this pivot hinge are rust-resistant. The argenta pivotica is suitable for indoor use of both modern residential buildings as well as public buildings and offices.

The argenta pivotica is preferably used in combination with the argenta magnotica® pro, a contactless doormagnet,

Benefits

- **Easy installation:** Opening angle in both directions up to 150°
- **Fixed settings:** at 90° in both directions
- **Free choice of rotating position:** hinge point
- **Adjustable outlining:** straight outlining
- **Pivot system:** to be mounted in the door panel and not (as usual) in the floor or ceiling.
- **Safety:** Child-friendly (easy to open)
- **Aesthetics:** Invisible, available for floor-to-ceiling-height doors, invisible door closer.

Technical Features

	Pivotica®
Material	Aluminium + stainless steel
Finishes	Brushed stainless steel
Door thickness	Minimum 40 mm
Door weight	Maximum 45 kg
Door width	1500 mm
Door height	3000 mm



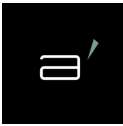

Technical Drawings

Upper part door opening

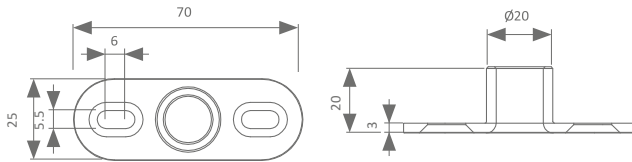

Lower part of door leaf

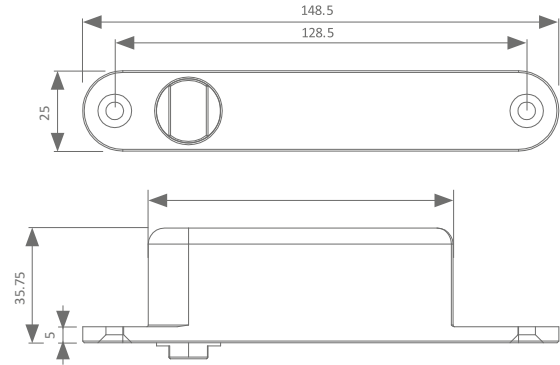

Upper part door leaf

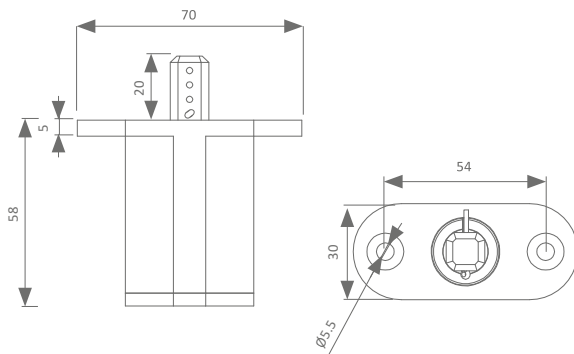

Lower part floor

